

## Property Highlights

- Tallahassee MSA
- Expansive trade area in fastest growing part of Tallahassee
- Directly located off of US-319
- Three dedicated entries
- Attractive facade and landscaping
- Co-tenants include: Subway, GNC, H&R Block, and Great Clips
- Traffic Count: 37,500 CPD

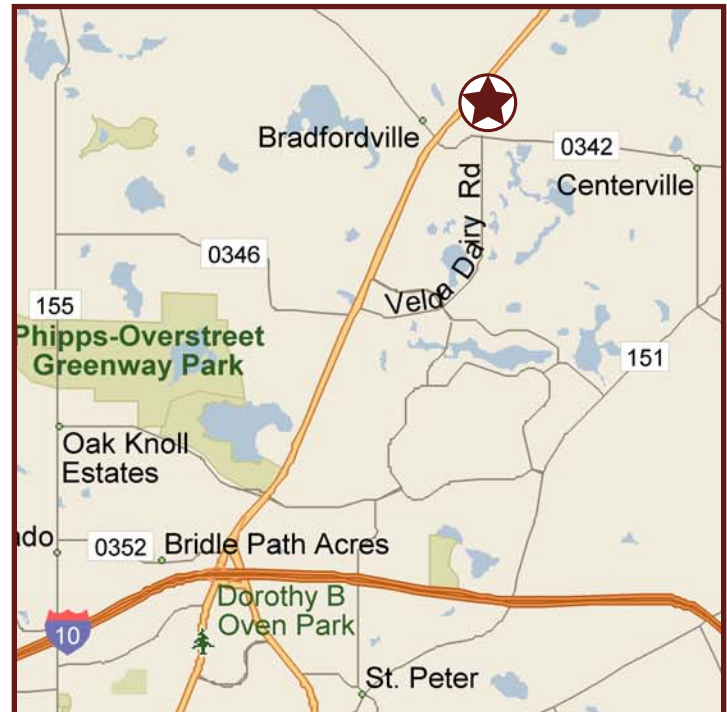

### Leasing Contact:

**Justin Greider**

407-581-6225

jpgreider@crossmanco.com

**Craig Katterfield**

407-581-6241

ckatterfield@crossmanco.com

For a complete directory of our listings visit our website:

**[www.crossmanco.com](http://www.crossmanco.com)**

No warranty expressed or implied has been made to the accuracy of the information provided herein, no liability assumed for error omission  
Licensed Real Estate Broker

## Site Plan

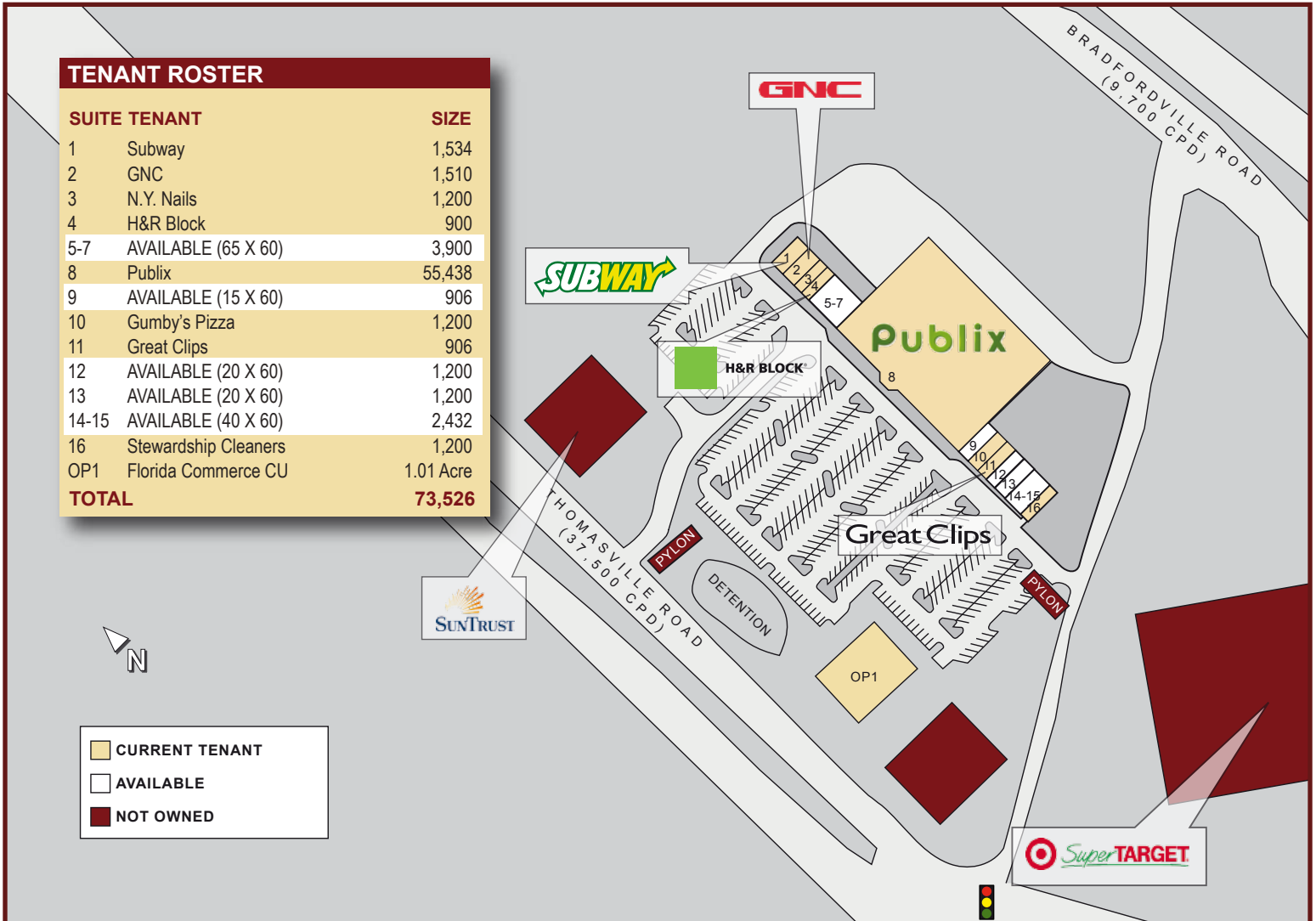

### Leasing Contact:

**Justin Greider**  
407-581-6225  
jgreider@crossmanco.com

**Craig Katterfield**  
407-581-6241  
ckatterfield@crossmanco.com

[www.crossmanco.com](http://www.crossmanco.com)

Demographics	1-Mile Radius	3-Mile Radius	5-Mile Radius
2010 Population	1,520	26,299	48,785
2015 Population	1,652	27,871	51,444
2010 Average HH Income	\$93,619	\$109,116	\$105,852
2015 Average HH Income	\$101,848	\$117,027	\$114,227